

Property Report

Location

Property Address	AZ
Subdivision	Arizona Sun Sites
Carrier Route	
County	Cochise County, AZ

Current Owner

Name	L190-1 Shadow Mountain Plat Llc
Mailing Address	10500 Ne 8Th St Ste 1725 Bellevue, WA 98004-4370

Property Summary

Property Type	Residential
Land Use	Vacant Land
Improvement Type	
Square Feet	

General Parcel Information

Parcel/Tax ID	114-18-001G
Township	17S
Range	25E
Section	19
Census Tract/Block	

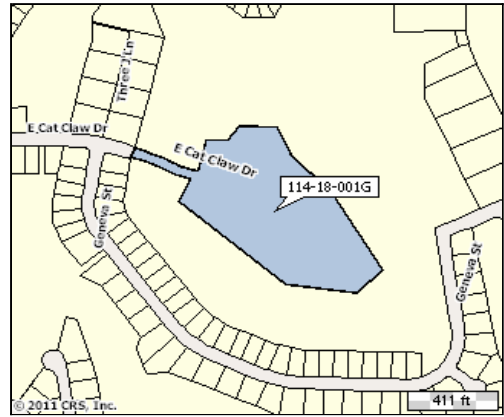

Sales History through 02/28/2011

Date	Amount	Buyer/Owners	Buyer/Owners 2	Instrument	Quality	Book/Page or Document#
11/01/2005		L190-1 Shadow Mountain Plat Llc		Warranty Deed		51142/253
11/01/2005	\$200,000	L190-1 Shadow Mountain Pla		Warranty Deed		0000042253

Tax Assessment

Assessment Year		2011	Tax Area	2278
Appraised Land		\$19,340	Tax Year	2009
Appraised Improvements		\$0	Total Taxes	\$474.54
Total Tax Appraisal		\$19,340	%Improvement	
Total Assessment		\$3,094	Exempt Amount	

Mortgage History

Date	Loan Amount	Borrower	Lender	Book/Page or Document#
11/1/2005	\$204,760	L190-1 Shadow Mountain Plat LI	Banex Capital	42254
6/8/2000	\$64,000	Searcy August & Melinda	Note Two	15986

Property Characteristics: Building

No Buildings were found for this parcel.

Property Characteristics: Extra Features

No extra features were found for this parcel.

Property Characteristics: Lot

Land Use	Vacant Land	Lot Dimensions	
Block/Lot	82/	Lot Square Feet	
Latitude/Longitude	31.944085°/-109.841085°	Acreage	9.67

Property Characteristics: Utilities/Area

Gas Source		Road Type	
Electric Source		Topography	
Water Source		District Trend	
Sewer Source		School District	Pearce Unified School District
Zoning Code			
Owner Type			

Legal Description

Subdivision	Arizona Sun Sites	Plat Book/Page	
Block/Lot	82/	Description	Arizona Sun Sites Blk 82 Sec 19 T17 R25 9.67Ac
Tax Area	2278		